

MORRISON®

Petrol Blower BL260E S2 & BL 260 S2 Including Engines 1E34F-2E & 1E34FB



Owner's Manual Important

Please read this Owner's Manual and the Express Warranty before using this product. The Warranty does not cover damage due to misuse or failure to follow the operating and assembly instructions.

Keep these instructions in a safe place for future use.



Do not operate this machine before it has been assembled correctly and you have read and understood these instructions.



These instructions are intended as a general guide and do not supersede national or local codes in any way. Contact local Authorities for clarity of laws relating to operation of this appliance.



Keep the instructions in a safe place for future use.

Contents

Warning Symbols on the Machine	2
Symbols in this Owner's Manual	2
Proper Use	3
Safety Instructions	3
Important Information!	3
Operation Warning!	3
List of Parts	3
Assembling the Blower	4
Mixing Fuel	4
Filling the Fuel Tank	4
Starting the Machine	5
Adjusting Engine Idle Speed	5
Stopping the Engine	6
Using the machine	6
Routine Maintenance	6
Spark Arrestor Maintenance	7
Storage for over 30 days	7

Warning Symbols on the Machine



Caution! Read the operating instructions and follow the warnings and safety instructions. This product is for outdoor use only and to be used in a well ventilated area.



Wear protective eye wear and ear muffs.

- 1. AVOID DANGEROUS WORK ENVIRONMENTS.** Do not use power tool in damp or wet locations or expose power tools to rain. Do not use power tools in the presence of flammable liquids or gases as normal sparking of the motor could ignite fumes. Keep work areas well lit.
- 2. KEEP CHILDREN AND VISITORS AWAY.** Visitors and children should wear safety glasses and be kept a safe

- distance from the work area. Do not let others make contact with the tool or extension cord.
- 3. AVOID UNINTENTIONAL STARTING.** Always check that the switch is in the OFF position before plugging in the tool to the power supply. Do not carry a plugged in tool with your finger on the switch.
 - 4. STORE TOOLS SAFELY.** When not in use, tools should be stored in a dry place, high and locked-up place, out of reach of children.
 - 5. DISCONNECT IDLE TOOLS.** Switch off the power and disconnect the plug from the power supply before servicing, when changing accessories and when the tool is not in use.
 - 6. DO NOT FORCE THE TOOL.** The tool will do the job better and safer working at the rate for which it was designed.
 - 7. USE THE CORRECT TOOL FOR THE JOB.** Do not force small tools or attachments to do the job of a heavier duty tool. Never use a tool for a purpose for which it was not intended.
 - 8. DRESS CORRECTLY.** Do not wear loose clothing or jewellery, they can be caught in moving parts. Rubber gloves and non-slip footwear and recommended when working outdoors. If you have long hair, wear a protective hair covering.
 - 9. ALWAYS USE SAFETY ACCESSORIES.** Safety glasses and earmuffs should always be worn. Everyday eyeglasses have impact resistant lenses only, they are not safety glasses. A face or dusk mask is also required if dust is going to be created.
 - 10. DON'T OVERREACH.** Keep proper footing and balance at all times. Do not use tool on a ladder or unstable support. Secure tools when working at elevated levels.
 - 11. MAINTAIN TOOLS WITH CARE.** Keep tools sharp and clean for better and safer performance. Follow instructions for lubricating and changing accessories. Inspect tool cords periodically and, if damaged have them repaired by an authorised service facility. Inspect extension cords periodically and replace them if damaged. Keep tool handles dry, clean and free from oil and grease. Never use brake fluids, gasoline, petroleum based products, or any strong solvents to clean your tools.
 - 12. REMOVE ADJUSTING KEYS AND WRENCHES.** Check to see that keys and adjusting wrenches are removed from the tool before switching it on.
 - 13. STAY ALERT AND EXERCISE CONTROL.** What was you are doing and use.



Warning! When in use, and in the cool down period after use this surface is very hot. Do not touch as doing so can result in serious burns.



BLOWER IMPELLER CAN CAUSE SERIOUS INJURY
Make sure to turn the engine off and wait for the impeller to come to a complete stop before opening the cage. Never insert hand into the tube while unit is on.



Warning! Keep hands and feet clear when machine is operating as rotating parts can cause serious injury.



Warning! Flammable fuel keep away from naked flames and cigarettes.

Symbols in this Owner's Manual



Threatened hazard or hazardous situation. Not observing this instruction can lead to injuries or cause damage to property.



Important information on proper handling. Not observing this instruction can lead to faults in the machine.



User information. This information helps you to use all the functions correctly. Keep this owners manual for future reference and for others who may want to use this tool.

Proper Use

For safety reasons, the blower is not to be used by children, young people under 16 years of age, or any other persons who are not acquainted with these directions for use.



Specific safety information Please read this safety information and the directions for use carefully and be sure to follow the instructions to the letter.



Failure to follow safety instructions can result in serious injury to yourself and others.

Safety Instructions

Use the machine only as described in this manual. Any other types of use are at your own risk and could well be dangerous. The manufacturer cannot be held liable for damage caused by improper or incorrect usage.



Warning!
Read the operating instructions in their entirety before using the machine for the first time. All the information on the handling of the machine is relevant to your personal safety. Ask a professional to show you to use the machine!



Do not operate this machine if you are tired, ill or are under the influence of alcohol, drugs or medicine.

This Owner's Manual covers two engine options for the BL260 Blower.

Before starting, check the machine is in good working order. If damage is discovered, have it repaired by a specialist immediately. Always wear goggles and protective ear muffs when working with the machine. Always switch off the machine before pulling it down. Always stop the engine before doing any work on the machine. Only one person must use the machine at a time. All other persons must stay clear of the Blower. Children and pets in particular must be kept well away at all times.

Important Information!

The information contained in this manual describes machines available at the time of production. While every attempt has been made to give you the very latest information about your Petrol Blower, there may be some differences between your machine and what is described here. We reserve the right to make changes in production without prior notice, and without obligation to make alterations to machines previously manufactured. Before using this product, consult local regulations concerning noise restrictions and hours of operation



Caution!

This petrol engine blower is equipped with a spark arresting muffler. Never operate this machine without both the muffler and spark arrestor installed and properly functioning!

Operation Warning!



Important!

The operational procedures described in this manual are intended to help you get the most from your machine and also to protect you and others from harm. These procedures are general guidelines only, and are not intended to replace any safety rules/laws that may be in force in your area. If you have any questions regarding your petrol engine blower, or if you do not understand something in this manual, your dealer will be glad to assist you.



Warning!

Do not make unauthorised modifications to this machine!

List of Parts

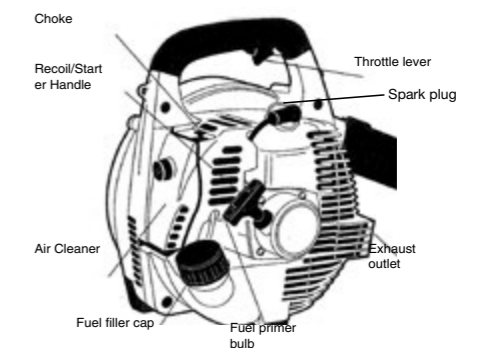

Assembling the Blower

Place the blower upright on the ground or on a sturdy work surface. Grasp the straight tube as shown, and push the tube over the blower discharge port and locking pins.

Lock the straight tube to the blower discharge port by rotating the tube as shown.

Grasp the nozzle tube with the label "TOP" positioned as shown, and then push the nozzle over the straight tube and locking pins.

Lock the nozzle tube to the straight tube by rotating the nozzle tube as shown.

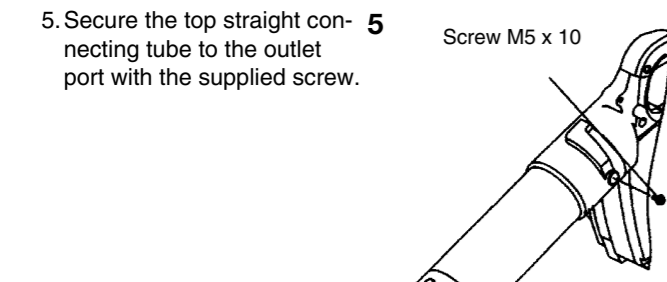
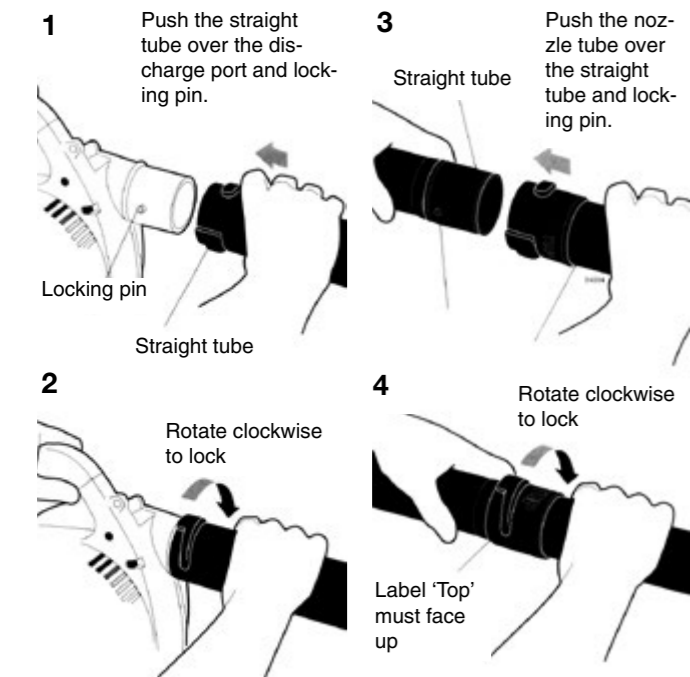

Important!

Blower tube installation affects both blower balance and performance! The tube and nozzle are correctly installed when the label "TOP" is visible to the operator during normal operation.



Warning!

Danger from rotating impeller! Stop the engine before installing or removing the blower tubes! Never perform any maintenance or assembly procedures on this machine while the engine is running!

Mixing Fuel

Fuel Requirements
Use only fresh, clean fuel

Use only fuel with an octane rating of 90 or higher

2 Stroke Oil / Fuel Mixing Ratios and Volumes

It is recommended to always use Masport oils as these are formulated for best results. If Masport oil is not available, check with a Service Dealer for a suitable alternative.



Important!

Check type of oil, 'Mineral Oil' or 'Semi Synthetic Oil'

First 20 Hours of Use

Use mixture of 25:1 = 40ml of oil for each one (1) litre of Petrol.

After First 20 Hours of Use

If Using Mineral Oil, it is recommend using a mixing Ratio of 25:1
Note - 25:1 = 40ml of oil for each one litre (1) of Fuel
if using Semi Synthetic Oil, it is recommended using a mixing Ratio of 40:1

Note - 40:1 = 25ml of oil for each one litre (1) of Fuel



Warning!

Incorrect amount of oil will cause failure of the motor, plus void any warranty claim. Incorrect oil or poor fuel can cause failure of the motor, plus void any warranty claim. Do not store fuel for longer than 3 months; as stale petrol can cause motor issues. Mix only the required amount of fuel for the task; ensure petrol is fresh.



Warning!

Danger of fire! Never transfer or store fuels in the presence of combustible materials! Before starting the engine, always move the blower to a clear area at least 10 feet (3 metres) away from fuels and other combustible materials!



Warning!

Never attempt to mix fuel in the blower fuel tank! Always mix all fuels in a clean, container! Use 2-stroke engine oil or equivalent oil mixed at the recommended ratio for your model. Be aware that generic oils and some outboard mixing oils may not be intended for use in high performance air cooled 2-cycle engines, and should never be used in your engine blower. If unsure seek advice from your garden product specialist. Add fuel in a well ventilated area. Wipe away an spilt fuel before starting the engine.



- Important! Mix only enough fuel for your immediate needs! If fuel must be stored longer than 30 days, it should first be treated with a stabiliser or equivalent product!

Filling the Fuel Tank



Warning!

Danger of fire and burn injury!

Place the blower upright on the ground or on a sturdy work surface, and wipe any debris from around the fuel cap.

Remove the fuel cap.

Fill the tank with clean, fresh fuel.

Replace the cap, and wipe away any spilled fuel before starting the blower.

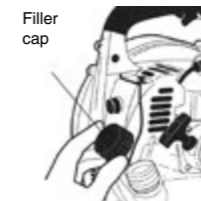

Always use extreme care when handling fuel! Fuel is highly flammable!

Never operate this blower if fuel system components are damaged or are leaking!

Never attempt to refuel the engine while it is running!

Never attempt to refuel a hot engine! Always allow the blower engine to cool before fuelling!

Never smoke or light any fires near the blower or fuels!

Always transport and store fuels in an safe container!

Never place flammable material close to the engine muffler!

Never operate the blower without a properly functioning muffler and spark arrestor installed!

Never operate the blower unless it is properly assembled and in good working condition!

Starting the Machine



Warning!

Danger from rotating impeller! The impeller will rotate whenever the blower is operated! Never operate this blower unless the intake cover and blower tubes are properly installed and in good working order. Danger from thrown dust or debris! Always wear eye protection when operating this machine! Never direct the blower stream toward people or animals! Never operate this blower unless all controls are properly installed and in good working order.



Warning!

- The recoil starter can be damaged by abuse!
- Never pull the starter cord to its full length.
 - Always engage the starter before cranking the engine!
 - Always rewind the starter cord slowly!
 - Never operate the blower if blower tubes are missing or damaged!



Important!

A two-position "ON-OFF" switch located on the left of the blower handle grip controls the engine ignition

Starting Procedure:

Prime the fuel system by repeatedly depressing the fuel primer bulb until no air bubbles are visible in the fuel discharge line.

Cold Engine Only. Choke the engine by pulling the choke control to the fully extended position (choke is closed).

Place the blower on the ground, and hold the blower handle firmly with your right hand.

Pull the starter cord slowly until you feel the starter engage, then start the blower by pulling the starter cord upward rapidly. If necessary, repeat two or three times until the engine starts.

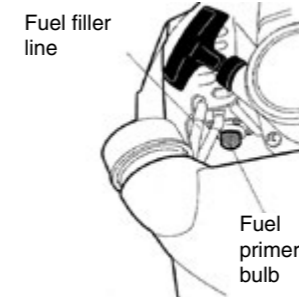

Important!

When the engine starts:

For maximum performance and operating life, allow the engine to warm before use.

Run the engine at idle speed until operating temperature is reached (2-3 minutes).

As the engine warms open the choke gradually by slowly pushing the choke control in to the fully retracted position.

The machine should now be ready for use.

If the engine does not start:

Repeat the appropriate starting procedure for "hot" or "cold" engine. If the engine still will not start, follow the "Starting a Flooded Engine" procedure (below).

Starting a flooded engine:

Disconnect the spark plug lead, and use the spark plug wrench to remove the plug in a counterclockwise direction.

If the spark plug is fouled or is soaked with fuel, clean or replace the plug as required.

Clear excess fuel from the combustion chamber by cranking the engine several times while the spark plug is removed.

Install the spark plug and firmly tighten it with the spark wrench.

If a torque wrench is available, torque the spark plug to 148-165 inch-pounds. Reconnect the spark plug lead.

Ensure the choke control lever is in the appropriate position for the temperature of the engine.

Repeat the starting procedures for "warm engine".

If the engine still fails to fire or start, refer to the troubleshooting flowchart at the end of this manual.

Choke control.
Pull to close

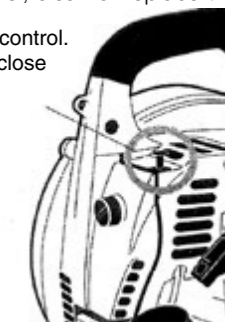

Adjusting Engine Idle Speed

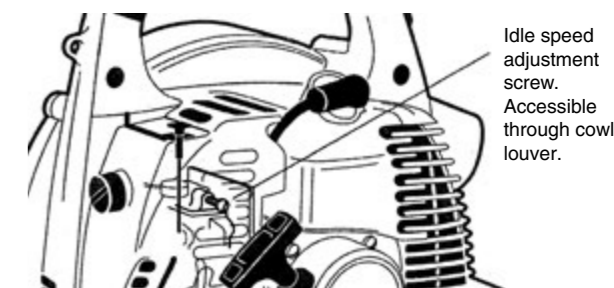

Start the engine by following the procedures described on the preceding pages.

Run the engine at idle speed until operating temperature is reached (2-3 minutes).

Use a screwdriver to adjust the engine idle speed to 2800-3000 rpm.

Turn the idle screw clockwise to increase engine idle speed.

Turn idle screw counterclockwise to decrease engine idle speed.

**Important!**

Blower tubes and the intake cover must be installed while adjusting engine idle! Engine idle speed will also be affected if either the intake cover or blower tubes are blocked, damaged or incorrectly installed!

Stopping the Engine

Cool the engine by allowing it to run at idle for 2 to 3 minutes. Stop the engine by pulling the ignition switch.

**Important!**

If the engine continues to run while pulling the ignition switch, stop the engine by pulling the choke control out to the fully closed position. A clean and unrestricted airflow is essential to your blower's engine performance and durability!

Before attempting any carburettor adjustments, inspect and clean the engine air cleaner as described under the heading 'Every 10 Hours', on Page 6 of this manual.

Using the machine**Think Safety!**

In the hands of an experienced operator, the machine can efficiently move a wide variety of debris ranging from grass clippings to gravel. As a general rule, try to operate your engine at the lowest throttle setting necessary to get the job done:

- Use low throttle settings when clearing lightweight materials from around lawns or shrubbery.
- Use medium to higher throttle settings to move lightweight grass or leaves from parking lots or walkways.
- Use full throttle when moving heavy loads such as dirt or snow.

**User Information!**

Noise increases at higher throttle settings! Always use the lowest throttle setting required to get the job done!

Safe operation

Machine noise increases at higher throttle settings! Always use the lowest throttle setting required to get the job done!
 Never operate the blower when visibility is poor.
 Always wear eye protection such as face shield or goggles while operating this machine.
 Wear a dust mask to reduce the risk of inhalation injuries.
 Wear close fitting clothing to protect your legs and arms.
 Wear hearing protection when operating this machine.
 Never operate the blower if any component parts are damaged, loose, or missing.

1. Using the blower

Always be aware of the strength and direction of stream. Never direct the blower discharge stream toward people or animals.

**Routine Maintenance****Warning!**

Before performing any maintenance on this blower, stop the engine and disconnect the spark plug wire!

Daily Maintenance

Remove dirt and debris from the blower exterior. Inspect the engine, tank, and hoses for possible fuel leaks, and repair as necessary. Inspect the engine cooling fins for accumulations of dirt or debris, and clean as necessary.

**Important!**

Dirty or damaged cooling system components may allow the engine to overheat, possibly causing serious engine damage!

**Important!**

Operating the blower with loose, missing, or damaged components could allow the engine to over speed, possibly causing serious engine damage!

Inspect the entire blower for damage, loose or missing components or fastenings, and repair as necessary.

EVERY 10 HOURS

More frequently in dusty conditions.

Loosen the air cleaner cover retaining screw, and remove the cover and filter element. Inspect the element. If the element is distorted or damaged, replace it with a new one. Wash the element in clean fuel, and squeeze or blow dry. Wash the air cleaner cover in clean fuel, and wipe air blow dry. Install the element and cover and then tighten the cover retaining screw.

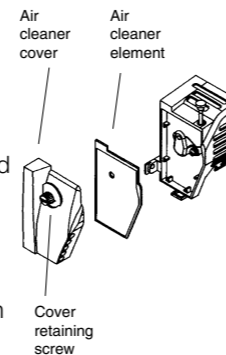
**EVERY 10/15 HOURS**

Use the spark plug wrench to remove the spark plug (turn counter-clockwise to remove).

Clean and adjust the spark plug gap to 0.6-0.7mm. Replace any damaged or visibly worn plug with the correct plug or it's equivalent

Install the spark plug finger tight in the cylinder head, then tighten it firmly with the spark plug wrench. If a torque wrench is available, torque the spark plug to 148-165 inch pounds.

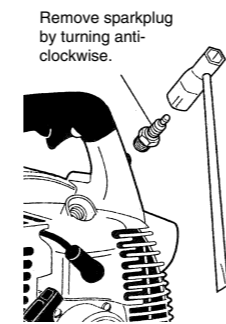
**Important!**

Never allow dirt or debris to enter the cylinder bore! Before removing the spark plug, thoroughly clean the spark plug and cylinder head area! Allow the engine to cool before servicing the spark plug! Cylinder tightening or loosening the spark plug while the engine is hot can result in serious engine damage! Incorrect spark plug installation can result in serious engine damage!

EVERY 50 HOURS

More frequently if you notice reduced performance.

INSPECTION

Inspect the entire blower and tubes for damage, including loose or missing components, and repair as necessary.

SPARK PLUG

Replace the spark plug with a Champion RCJ6Y, gapped to (0.6-0.7)mm.

FUEL FILTER

Use a wire hook to extract the fuel filter from inside the fuel tank, and then remove and wash the filter element in clean fuel. Before reinstalling the filter, inspect the condition of the fuel line. If damage or deterioration is noted, the blower should not be used until it can be inspected by a trained service technician.

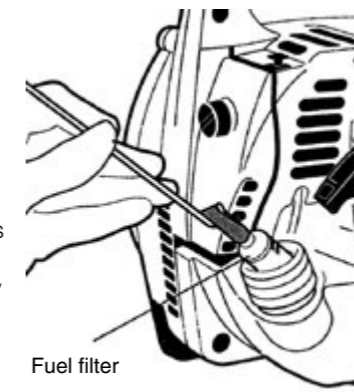
**COOLING SYSTEM**

Remove the engine cover (as described under 'Spark Arrestor Maintenance'), and use a wood or plastic scraper and a soft brush to remove dirt and debris from the cylinder fins and crankcase.

Spark Arrestor Maintenance

Hard starting or gradual loss of performance can be caused by carbon deposits lodged in the spark arrestor screen. For maximum performance, the spark arrestor screen should be periodically cleaned as follows:

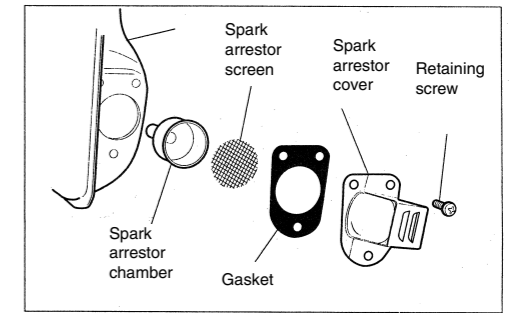
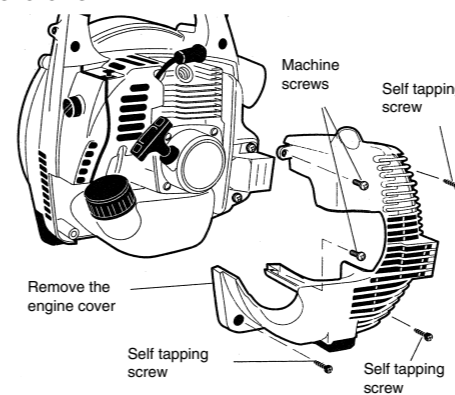

Remove the spark plug.

Remove three self tapping screws and two machine screws from the engine cover, and then gently move the engine cover aside. Remove the three spark arrestor retaining screws, and then remove the spark arrestor cover, screen, gasket, and chamber. Use a plastic scraper or wire brush to remove carbon deposits from the arrestor screen, chamber, and cover.

Inspect the screen carefully, and replace any screen that has been perforated, distorted, or is otherwise unserviceable. Install the chamber, screen, gasket and cover in the reverse order of disassembly, and then install and securely tighten the three cover retaining screws.

Install the engine cover, and verify that the fuel line connections are still tightly in place.

Install the engine cover retaining screws in the reverse order of removal, and tighten securely.

Install and tighten the spark plug, and reconnect the spark plug wire.

Drain the fuel if it is to be stored for an extended time.

**Important!**

Always replace cover screws in the same holes from which they were removed. Substitution or incorrect assembly of the engine cover screws can permanently damage aluminium castings and plastic components!

Storage for over 30 days

CLEANING Thoroughly clean the machine exterior.

INSPECTION Inspect the entire machine and tubes for damage, including loose or missing components, and repair as necessary.

FUEL Drain the fuel tank, and then clear the carburettor and lines by running the machine until it stops from lack of fuel.

LUBRICATION Remove the spark plug, and then pour approximately 1/4-oz of oil into the cylinder through the spark plug hole. Before reinstalling the spark plug, pull the recoil starter 2 or 3 times to distribute the oil over the cylinder walls.

AIR CLEANER Remove, clean, and reinstall the filter element as described under "daily maintenance."

STORAGE Store the machine in a clean, dry, dust free environment.

**Warning!**

Never store the machine with any fuel remaining in the tank, fuel lines, or carburettor! Your warranty does not include coverage for damage caused by 'stale' or contaminated fuels!

Engine does not start

What to Check	Possible Cause	Remedy
Does the engine crank?	Faulty recoil starter. Fluid in the crankcase. Internal damage.	Return blower to dealer
Good compression?	Loose spark plug. Excess wear on cylinder, piston, rings.	Tighten and re-test. Return blower to dealer
Does the tank contain fresh fuel of the proper grade?	Fuel/mixture incorrect, stale, contaminated.	Re-fill with fresh fuel (2-cycle engine oil and gasoline)
Is fuel visible and moving in the return line when priming?	Check for clogged fuel filter and/or vent.	Clear as required. Re-start.
Check the spark plug	If the plug is wet, excess fuel may be in the cylinder.	Crank the engine with plug removed, replace the plug and restart.
	The plug may be fouled or improperly gapped	Clean and regap the plug to 0.6-0.7mm. Restart.
	The plug may be damaged internally or of the wrong size.	Replace the plug with a Champion RCJ6Y. Restart

Low Power Output

What to Check	Possible Cause	Remedy
Is the engine overheating?	Operator is overworking the machine.	Use lower throttle setting.
	Carburettor mixture is too lean.	Return blower to dealer.
	Improper fuel ratio.	Re-fill with fresh fuel of the correct mixture (2-cycle engine oil and gasoline)
	Fan cover, cylinder fins dirty or damaged.	Clean, repair or replace as necessary.
Engine is rough at all speeds. May also have black smoke and/or unburned fuel at the exhaust.	Carbon deposits on piston or in the muffler.	Decarbonize.
	Clogged air cleaner element.	Service the air cleaner.
	Loose or damaged spark plug.	Tighten or replace.
	Air leakage or clogged fuel line.	Repair or replace filter and/or fuel line.
	Water in the fuel.	Drain the fuel dealer replace the fuel.
	Piston seizure.	Return blower to dealer.
Engine is knocking.	Faulty carburettor and/or diaphragm.	Return blower to dealer.
	Overheating condition.	Idle engine until cool; find reason for overheat.
	Improper fuel.	Check fuel octane rating; check for presence of alcohol in the fuel. Refuel as necessary.
	Carbon deposits in the combustion chamber.	Decarbonize.

Additional Problems

Symptom	Possible Cause	Remedy
Poor acceleration.	Clogged air cleaner element.	Clean the element.
	Clogged fuel filter.	Replace the fuel filter as required.
	Carburettor mixture too lean.	Return blower to the dealer.
	Idle speed set too low.	Adjust: 2800-3000 rpm.
Engine stops abruptly.	Fuel tank empty.	Refuel.
	Clogged fuel filter.	Clean or replace the fuel filter as required.
	Water in the fuel.	Drain; replace with clean fuel.
	Shorted spark plug or loose terminal.	Clean and replace spark tighten the terminal.
	Ignition failure.	Return blower to the dealer.
	Piston seizure.	Return blower to the dealer.
Engine difficult to shut off.	Ground (stop) wire is disconnected, or switch is defective.	Test and replace as required.
	Overheating due to incorrect spark plug.	Correct plug: Champion RCJ6Y
	Overheated engine.	Idle engine until cool.
Excessive vibration.	Warped or damaged blower fan.	Inspect and replace fan as required.
	Loose bolt or fastener.	Tighten as required.
	Internal engine damage.	Return blower to dealer.

Specifications

Model	BL-260 S2	BL-260E S2
Dimensions	325l x 230h x 330w	325l x 230h x 330w
Engine	Two stroke air cooled petrol/oil engine, vertical cylinder	Two stroke air cooled petrol/oil engine, vertical cylinder
Engine Model	1E34FB	1E34F-2E (EU V)
Bore & Stroke	34 x 28	34 x 28
Displacement	25.4cc	25.4cc
Fuel	Gasoline/oil mixture	Gasoline/oil mixture
Carburettor	Diaphragm-type with primer pump	Diaphragm-type with primer pump
Ignition	All transistor electronic ignition system	All transistor electronic ignition system
Spark plug	Champion RCJ6Y	Champion RCJ6Y
Starting	Recoil starter	Recoil starter
Stopping	Grounding (toggle switch)	Grounding (toggle switch)
Fuel Tank Capacity	0.5 Litre	0.5 Litre
Exhaust system	Low dB; spark-arrestor muffler	Low dB; spark-arrestor muffler
Air Cleaner Type	Semi-wet	Semi-wet
Weight; dry, fully assembled	4.2kg	4.6kg
Performance	0.75kw	0.70kw
Engine Idle Speed	2800 +/- 150 rpm	2800 +/- 150 rpm
Sound	112dB(A)	109dB(A)

Morrison, a division of Masport Limited
1-37 Mt Wellington Highway, Panmure
Auckland 1060
New Zealand
P: 0800 627 767

Masport Australia Pty Limited
1/40 Abbots Road, Dandenong
South Victoria 3175
Australia
P: 1300 366 225

MORRISON[®]