

Petrol Line Trimmers & Brushcutters

BC 230B S2 / BC 260B S2 / BC 325 S2 / BC 260 S2 / BC 260E/B S2

Includes engines: 1E34F-2E and 1E34F



Owner's Manual

Important

Please read this Owner's Manual and the Express Warranty before using this product. The Warranty does not cover damage due to misuse or failure to follow the operating and installation instructions.

Keep the instructions in a safe place for future use.

Contents

SYMBOLS ON THE MACHINE	3
SYMBOLS IN THIS OWNER'S MANUAL	3
PROPER USE	3
BC 230B S2, BC 260B S2 & BC 260E/B S2 PARTS LOCATION	4
BC 260 S2 PARTS LOCATION	4
BC 325 S2 PARTS LOCATION	5
BEFORE BEGINNING WORK	6
SAFETY PRECAUTIONS	6
NOTES ON TRANSPORTATION	6
ASSEMBLY	7
FUEL	8
OPERATING	8
MAINTENANCE	9
AFTER 25 HOURS USE	10
AFTER 100 HOURS USE	10
SPECIFICATIONS	11
RECOMMENDED CUTTER APPLICATIONS	11



Do not operate this machine before it has been assembled correctly and you have read and understood these instructions.

Keep the instructions in a safe place for future use.

Symbols on the Machine

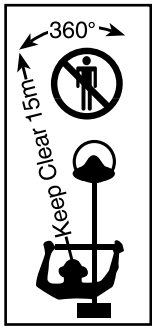

READ OWNER'S MANUAL



ALWAYS USE SAFETY GUARD



CHOKE CLOSED



CHOKE OPEN



WEAR PROTECTIVE GOGGLES OR FACE PROTECTOR



KEEP CLEAR 15M



KICKBACK



WEAR SAFETY GLOVES



WEAR SAFETY BOOTS



WEAR EYE, EAR HEAD PROTECTION

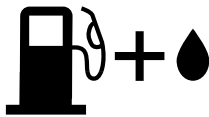

**2 STROKE FUEL MIXTURE
USE 25ml OIL PER LITRE OF PETROL**

Symbols in this Owner's Manual



Threatened hazard or hazardous situation.

Not observing this instruction can lead to injuries or cause damage to property.



Important information on proper handling.

Not observing this instruction can lead to faults in the machine.



User information. This information helps you to use all the functions correctly.

Proper Use

For safety reasons, the Brushcutters are not to be used by children, young people under 16 years of age, or any other persons who are not acquainted with these directions for use.

Specific safety information Please read this safety information and the directions for use carefully and be sure to follow the instructions to the letter.

1. This machine should never be used for anything other than the purpose for which it has been designed.
2. Do not use this brush cutter when tired or drowsy or under the influence of medication or alcohol, or at any time when you may not be able to operate it safely.
3. Avoid running the engine indoors. The exhaust gases contain

harmful carbon monoxide.

4. Never use the machine in the circumstances described below:
 - When the ground is slippery or when other conditions exist which might make your footing unsteady.
 - At night or in times of fog where it would not be possible to have a clear view of the cutting area.
 - During rain or electrical storms, during gale force winds or at any time when weather conditions might make use of the product unsafe.
5. Before using this product for the first time, get an experienced operator to show you how to use the machine.
6. When you are new to the machine, limit your work sessions to 30-40 minutes with a 10 minute break between, and a total working time of 2 hours per day. Accidents can be caused by tiredness and physical exhaustion.
7. Be sure to keep this manual handy so that you may refer to it later if any questions arise.
8. Always be sure to include this manual when selling, or lending, this machine.
9. Never allow children or anyone to use this machine if they cannot fully understand the directions given in this manual.

WORKING GEAR AND CLOTHING

When using your brush cutter, you should wear long, close fitting trousers and protective equipment as follows.

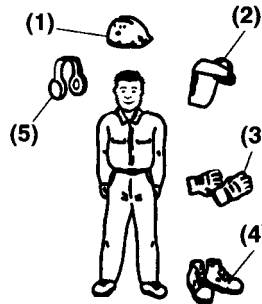

- (1) Helmet
- (2) Protection goggles or face protector
- (3) Thick work gloves
- (4) Non-slip-sole work boots
- (5) Ear protectors

You should carry with you the following things as appropriate.

- a. Reserve fuel
- b. A spare blade
- c. Something to indicate your working area. (Yellow rope, warning signs)
- d. Hatchet or saw (for removal of obstacles)

Never use your brush cutter when barefoot or in sandals or wearing trousers with loose cuffs.

FUEL HANDLING WARNING

1. The engine of this product is designed to run on a mixture of highly flammable petrol and oil. Do not store cans of fuel or refill the fuel tank in any place where there is a boiler, stove, wood fire, electrical or welding sparks, or any other source of heat or fire which might ignite the fuel.
2. Smoking while operating the brush cutter or refilling its fuel tank is extremely dangerous. Always be sure to keep lit cigarettes away from the brush cutter at all times.
3. When refilling the tank always turn off the engine first, wait for it to cool, and take a careful look around to make sure that there is nothing nearby which might ignite spilled fuel.
4. To avoid spilling fuel, always use a funnel when filling the fuel tank.
5. If any fuel spillage occurs during refuelling, use a dry rag to wipe up the spillage before starting the engine again.
6. After refuelling, screw the fuel cap back tightly onto the fuel tank and then carry the brushcutter to a spot 3m or more away from where it was refuelled before starting the engine.

BC 230B S2, BC 260B S2 & BC 260E/B S2 Parts Location

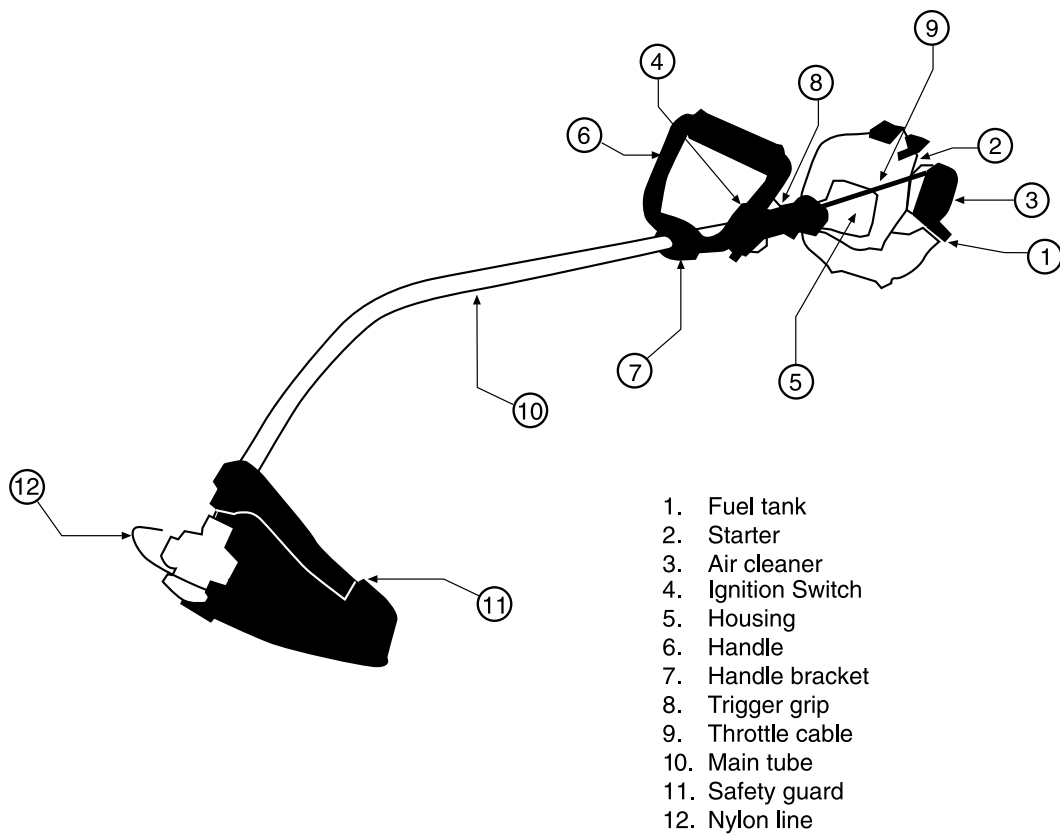

BC 260 S2 Parts Location

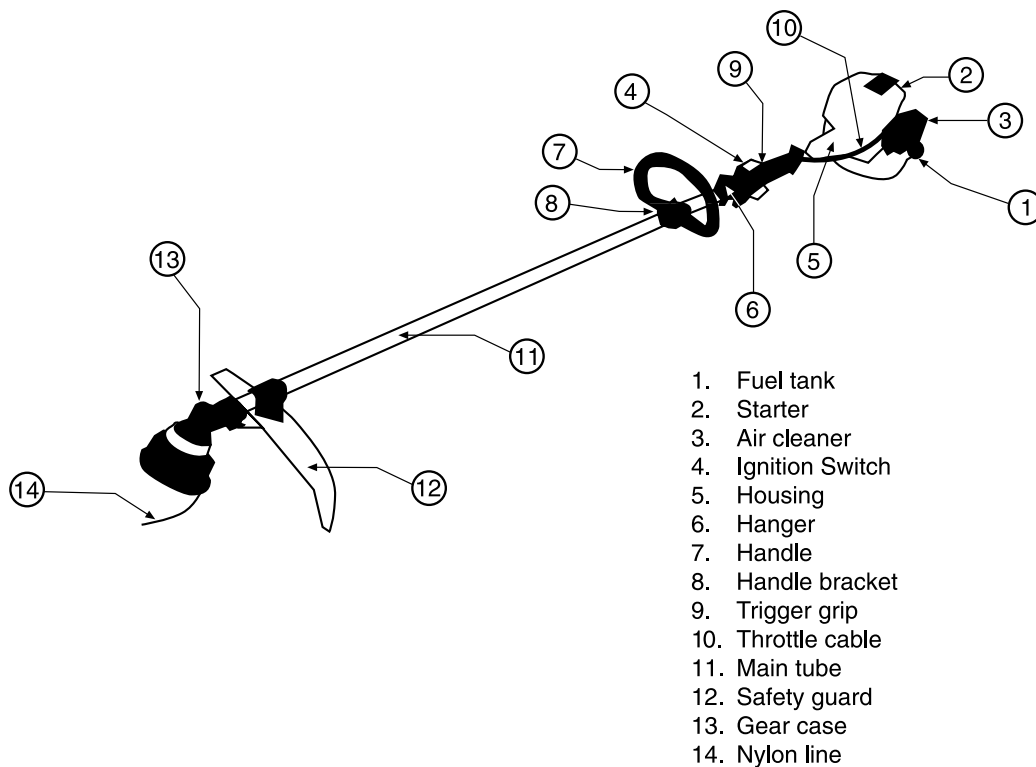

BC 325 S2 Parts Location

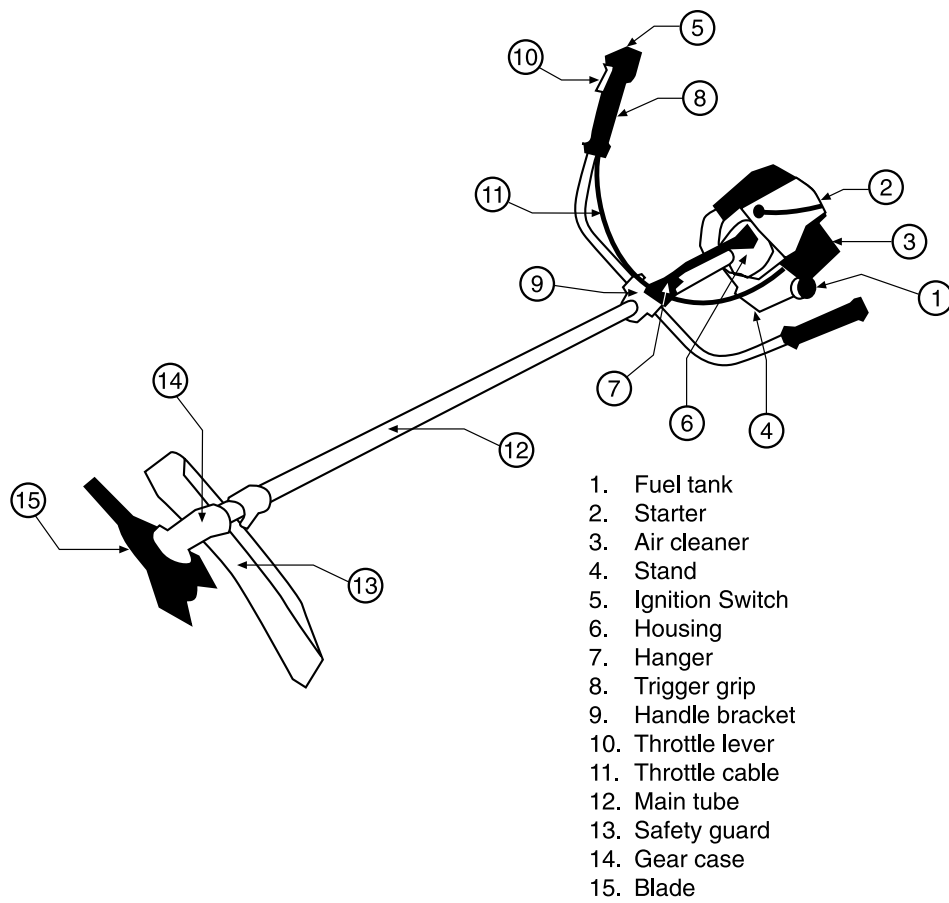

Before Beginning Work

1. Before beginning work, check the worksite carefully to see whether there are any obstacles to be removed or avoided and whether there are any potholes or obstructions which might cause you to lose your footing.
2. The area within a radius of 15m of the brush cutter should be considered a hazardous area into which no one should enter while the brush cutter is in use. If necessary, yellow warning rope or warning signs should be placed around the work area. When work is to be performed simultaneously by two or more persons, constantly be aware of the location of other operators to maintain a safe separation distance.
3. Make sure that there are no loose screws or bolts, fuel leaks or any other problems, which might result in unsafe operation. Be especially careful to check the blades and their fastening arrangements.
4. Never use blades that are bent, warped, cracked, broken or damaged in any way.
5. Always keep metal blades sharp by filing the cutting edges, particularly at the outer ends. There should be a radius at the inside end of the cutting edge.
6. Check the blade fastening bolt and be sure the blade turns smoothly without abnormal noise.

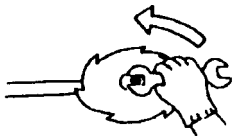
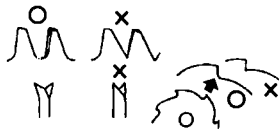

7. Ensure that the blade is securely tightened before use.

Safety precautions

Before Starting the engine

1. Take a careful look around to make sure that there are no obstacles within a radius of 15m around the brush cutter.
2. Place the body of the brush cutter onto the ground in a flat clear area and hold it firmly in place to ensure that the blades will not contact anything when the engine starts.
3. Place the trigger grip in the START position when starting the engine. Do not start the engine at full speed. (See STARTING THE ENGINE, page 8.)
4. After starting the engine, if the blades continue to rotate when the trigger grip has been released to the idle position, turn off the engine and check that the trigger grip cable is functioning correctly.



KICKBACK SAFETY PRECAUTIONS

A dangerous reaction may occur if the spinning blade contacts a solid object. It is called kick back. As a result, the operator can lose control of the unit, resulting in a serious accident.

To avoid kick back, observe the following safety precautions:

1. Before beginning work, check your working area and remove any obstacles.
2. Grip your brushcutter only by the handles.
3. When using your brushcutter, always look closely at where you are cutting. If you need to look away, set the engine to idling speed.
4. When the engine is running, always keep the cutter head well away from your feet, and never lift it above waist level.

OPERATING SAFETY PRECAUTIONS

1. Grip the brush cutter firmly with both hands, using the correct hand positions. When not cutting, set the engine speed to idling.
2. Always be sure to maintain a safe footing while working.
3. Run the engine no faster than the speed required to cut cleanly.
4. If grass gets caught in the blade during operation, or if you need to check the unit or refuel the tank, always be sure to turn off the engine.
5. If the blade touches a hard object like a stone, immediately stop the engine and check the blade. If necessary, replace the blade by new one.
6. If someone calls out while you are working, always be sure to turn off the engine before turning around.
7. Never touch the spark plug or plug cord while the engine is running. Doing so may result in receiving an electrical shock.
8. Never touch the muffler, spark plug, or other metallic parts of the engine while the engine is running or immediately after shutting down the engine as serious burns may result.
9. Stop the engine when moving from one work location to another.



SAFETY MAINTENANCE

1. Perform the regular maintenance procedures described in this manual. Repair and maintenance procedures other than those detailed in this manual should be carried out only by an authorised service dealer.
2. Under no circumstances should you take apart the brushcutter or alter it in any way. Doing so can result in damage to the machine, and may negate the manufacturer warranty.
3. Always be sure to turn off the engine before performing any maintenance or checking procedures.
4. To prevent injury when sharpening, removing, or reattaching the blade, be sure to wear thick, sturdy gloves and use only proper tools and equipment.
5. When replacing the blade or any other parts, always be sure to use only genuine MORRISON spares.

Notes on transportation



1. If a metal cutting blade is fitted, wrap it with a cloth to cover the sharp cutting edges.
2. When transporting by car, fix the unit firmly using a rope. It is dangerous to transport the brushcutter by cycle or motorcycle.
3. When travelling distances or over rough roads, fuel may spill from the tank. To avoid this, empty the tank before the journey.

Assembly

THROTTLE CABLE AND IGNITION WIRES

(BC 260 S2 and BC 325 S2 only)

1. Connect the two ignition wires running from the trigger grip to the two wires on the engine. (The order does not matter).
2. Remove the engine air cleaner cover and pass the end of the throttle wire through the brass adjusting nut on top of the carburettor.
3. Hold the carburettor butterfly fully open and drop the throttle wire into the slot of the wire anchor, making sure that the bulb on the end of the wire fits into the end of the slot that is enlarged.

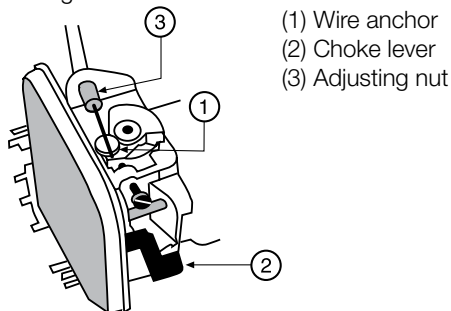

4. Check that, when the trigger grip is in the released (idle) position, there is 1 or 2 mm slack in the throttle wire.
5. Alter the brass adjusting nut if necessary to achieve this.
6. Refit the air cleaner cover.

HANDLE (BC 325 S2 only)

1. Loosen the 4 bolts on the handle bracket.
2. Insert the right handle (the one with the trigger grip) and the left handle assembly into the bracket as illustrated and retighten the bolts securely.

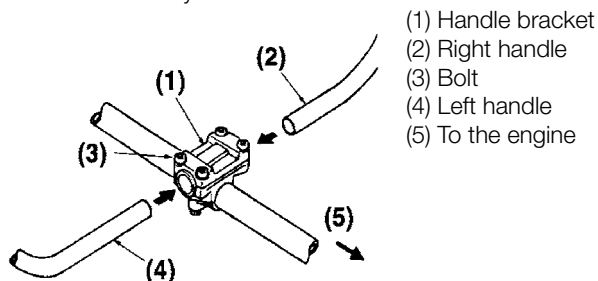

SAFETY GUARD

Attach the safety guard to the lower end of the main tube. The BC 230B S2 and BC 260B S2 guard is fastened with two Do not operate this unit without a safety guard, if the safety guard is damaged replace immediately. Do not continue with a damaged guard.

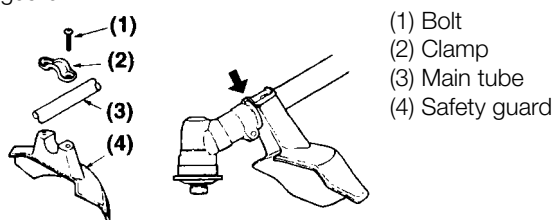

Do not operate this unit without a safety guard, if the safety guard is damaged replace immediately. Do not continue with a damaged guard.

INSTALLING THE METAL BLADE (not included in all models) (BC 260 S2 and BC 325 S2)

1. Turn the inner flange until it can be locked in position with the 'L' shaped locking bar inserted through the outer shroud.
2. Blades can only be used on straight shaft models blade to the projection on the inner flange. In the case of Put the blade on the inner flange, matching the hole in the the 80 & 8 tooth blades, ensure that the numbers stamped on the blade are toward the gear case. The 3 tooth blade can go either way and can be reversed when one set of cutting edges is blunt.
3. Fit the flange outer over the gear shaft.
4. Fit the Locking washer onto the outer flange, then fit and tighten the left hand threaded retaining nut. (Turn anticlockwise to tighten).
- 5.

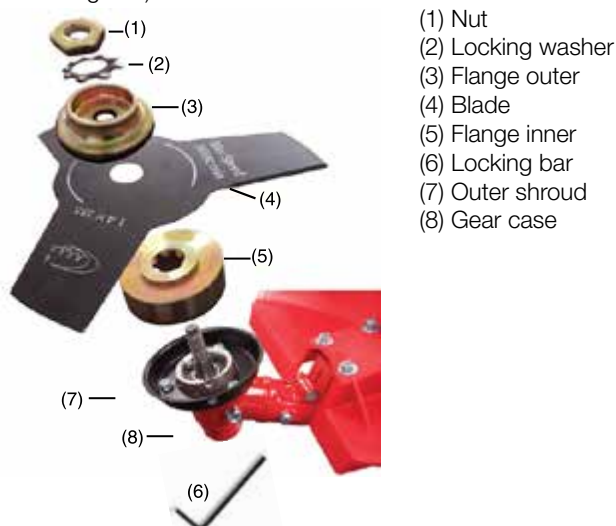

INSTALLING THE NYLON CUTTER

(BC 230B S2 and BC 260B S2)

1. Screw the nylon cutter head clockwise onto the shaft. (The black head has a RIGHT HAND THREAD).
2. When the cutter head reaches the hexagon fitting, use a spanner on the hexagon to hold it while turning the cutter head clockwise as far as possible by hand.

INSTALLING THE NYLON CUTTER HEAD

(BC 260 S2 and BC 325 S2)

1. Make sure the inner flange is fitted correctly on the gear shaft and turn it until it can be locked in position with the 'L' shaped locking bar inserted through the outer shroud.
2. Screw the nylon cutter head anti-clockwise onto the shaft, because it has LEFT HAND THRE AD.
3. Use the 'L' shaped bar to prevent the inner flange from turning while screwing the nylon cutter assembly onto the shaft. Hand tighten only.

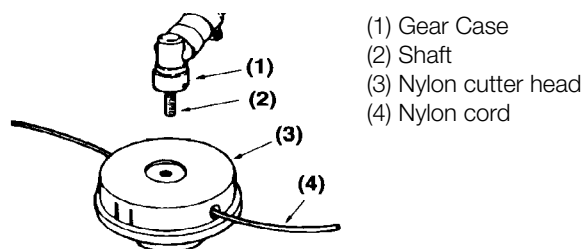

Fuel



1. Petrol is very flammable. Avoid smoking or bringing any flame or sparks near fuel.
2. Wipe up all spills before starting the engine.
3. Stop the engine and allow it cool before refuelling the unit.
4. Keep open flames away from the area where fuel is handled or stored.



5. Use only oil intended for 2 stroke air cooled engine use. Other oils can cause spark plug fouling, exhaust port blocking, or piston ring sticking.
6. Fuel mixtures which have been left unused for an extended period may clog the carburettor or cause hard starting. Store unused fuel in an air-tight container in a cool place.
7. Mix a regular grade petrol (lead or unleaded) and a good quality two stroke engine oil for air cooled engines. Shake them together in a clean container to ensure thorough mixing before pouring into the fuel tank. Do not use plastic containers not specifically designed for use with petrol.



8. When using a mineral oil:

Mixing ratio 25:1

Gasoline litres:	1	2	3	4	5
2 cycle oil ml:	40	80	120	160	200

When using a semi-synthetic mineral oil:

Mixing ratio 40:1

Gasoline litres:	1	2	3	4	5
2 cycle oil ml:	25	50	75	100	125

- Squeeze the throttle lever (1) fully. Hold down the starting button (3) while releasing the throttle lever.
- The throttle lever will be held partly open until it is squeezed again.

- (1) Throttle lever
- (2) Ignition Switch
- (3) Starting button.
- (4) Safety Lever

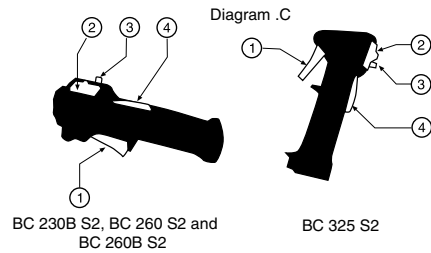

7. While holding the unit firmly, pull out the starter rope quickly.
8. After the engine has started, open the choke gradually.
9. Allow the engine to run for 2 to 3 minutes to warm up before starting work.

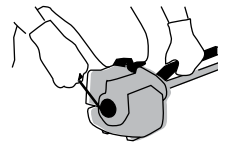

STOPPING THE ENGINE

1. Release the throttle lever.
2. Slide the ignition switch on the trigger grip to the STOP position.

USING THE SHOULDER STRAP

(BC 260 S2) (Not illustrated)

The use of the shoulder strap is optional, but it helps carry the weight of the machine and reduces operator fatigue.

1. Slip the head and right arm through the strap so that it is hanging from the left shoulder.
2. Before starting the engine, clip the hook into the hanger loop on the main tube and adjust the strap length to achieve the correct angle between the ground and the cutting head.
3. Unclip the hook before starting the engine.

FITTING THE HARNESS (BC 325 S2)



The harness on the BC 325 S2 must always be used as the machine cannot be operated safely without it.



1. Fit the horseshoe shaped plastic shoulder pad around your neck (open end of pad facing forward), and slide your arms through the side loops. The small rectangular belt cushion will be at your left side and the larger pad and hook clip will be on your right.
2. Adjust the various belt clips as necessary and fasten the buckle across your waist.
3. Before starting the engine for the first time, try hooking the hook clip into the various holes in the hanger along the top of the main tube to find out which hole gives the best machine balance.
4. Adjust the length of the strap holding the hook clip to achieve the correct angle between the ground and the cutting head. Note that the entire main tube of the machine can rotate to help achieve the correct cutting posture.
5. Unhook the clip before starting the engine.

Operating

STARTING THE ENGINE

Before starting the engine, inspect the entire unit for loose fittings or fuel leaks, and verify that the cutting attachment is properly installed and securely fastened.

Place the unit on a flat, firm place. Keep the cutting head clear of any obstructions.

1. Check that there is fuel in the tank and that the fuel cap is screwed on tightly.

- (1) Cap
- (2) Fuel tank

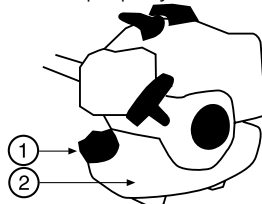

Diagram .A

2. When starting a cold engine move the choke lever (behind the air cleaner cover) to the closed position.

- (1) Choke lever
- (2) Closed
- (3) Open



Diagram .B

3. If the engine has been running and is still warm, move the choke lever to the open position.
4. Press the priming bulb under the carburettor repeatedly until excess fuel can be seen returning to the tank through the clear fuel return pipe.
5. Slide the ignition switch (2) on the trigger grip away from the STOP position (See Diagram .C on the next column).
6. To set the throttle in the start position.
 - Depress the safety lever (4)

QUICK-RELEASE MECHANISM

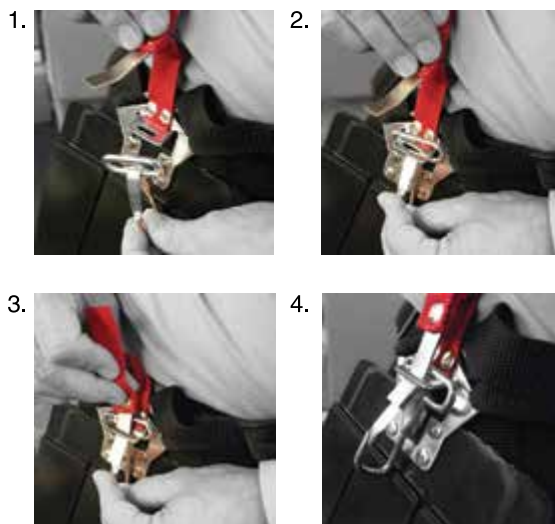

Above images illustrate how to use quick release mechanism

- In an emergency, release the throttle trigger and shut off the engine. Above images illustrate how to use quick release mechanism. Support the machine with your left hand and operate the quick-release mechanism. Be aware that the machine will fall and a rotating blade or nylon trimmer can cause death or severe injury.



WARNING

- Be careful not to accidentally operate the quickrelease on the harness. Be aware that the machine will fall and that a rotating blade or nylon trimmer can cause death or severe injury.

CUTTING USING THE METAL BLADE

- (1) For shrubs & thick weeds
- (2) For grass and weeds
- (3) Direction of cutting
- (4) Direction of rotation

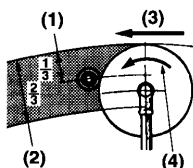

1. A metal blade cuts best with a swathe up to one third of the cutter diameter. Use that area for cutting shrubs, tough and thick weeds. For cutting young grass, you can use up to two thirds of the cutter diameter.
2. Adjust the engine speed according to the material being cut. Cut the young grass at middle speed, and shrubs or tough and thick weeds at high speed.



If the cutting speed is too low, debris can be caught up in the blade, and if this causes the clutch to slip it will wear out quickly.

CUTTING WITH THE NYLON CUTTER

- **Cutting with the nylon cord consumes more power so the engine speed should be 50% greater than when using the metal blade.**
- The nylon cord cuts the grass by meeting it at high speed. If you take too wide a swathe you may slow down the engine and not get clean cutting. To correct this, retract the cutter from the grass until the engine regains full speed and then cut using a narrower swathe.
- After a time the nylon cord will wear away. To restore the full cutting diameter, simply bump the cutter head on the ground while it is running at full speed. The cords will extend automatically and will be trimmed to the correct length by the cord trimmer blade mounted on the guard.

- **Cut grass by swinging the brushcutter from right to left with the BC 230B S2 and BC 260B S2 models, and left to right with the BC 260 S2 and BC 325 S2 models.** While you can cut in either direction, if you follow these suggestions the cut grass will be thrown away from you, and you will avoid getting your clothes dirty.

Maintenance

BLADE

- Sharpen each cutting edge and make sure the inside corner is rounded to reduce the risk of cracking.
- Do not quench the blade with water if you are using a grinder as it may start cracks in the blade.
- The 3 tooth blade on the BC 260 S2 and the BC 325 S2 may be inverted to utilise a fresh set of cutting edges.



NYLON CUTTERS

The spools of nylon cord inside these bump-feed cutter heads will eventually need replacing. While the change can be made with the cutter head on the machine, it will be more convenient to remove the cutter head.

BC 230B S2 and BC 260B S2.

Fit a spanner to the hexagon and unscrew the head (**turn anti-clockwise**). Unscrew the bump cylinder from the head (**anti-clockwise**). It may be necessary to turn the spool slightly to free it from the housing. Do not lose the spring beneath the spool. Feed the ends of the cords through the holes in the sides of the head before fitting the replacement spool. Re-fit the bump cylinder and re-mount the head on the spindle.

BC 260 S2.

Lock the spindle with the L shaped bar through the hole in the outer shroud into the hole in the inner flange and unscrew the cutter head by turning **clockwise** (LEFT HAND THREAD). The cover on the bottom of the housing can be removed by squeezing inwards (or prying with a screwdriver) on opposite sides of the housing skirt at points below the 'PUSH TO OPEN' markings on the top of the housing. The spool can then be removed from the housing. Do not lose the spring behind the spool.

When fitting the replacement nylon, run the nylon from the inner half of the spool through the small notch in the rim and feed the ends of the cords through the holes in the housing skirt before sliding the spool into the housing. The bottom cover will snap into place only when it is turned to the correct position relative to the housing.



Note: both nylon cords need to be wound in the same direction.

AFTER 25 HOURS USE

AIR CLEANER

Check the filter element and clean it in warm, soapy water as required. Dry completely before installing. If the element is broken or shrunk, replace with a new one.

(1) Air Cleaner element.

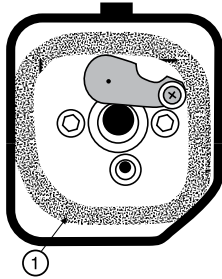

A clogged air filter will increase fuel consumption and cut down the engine power.



If you operate the brushcutter without the air filter or with a deformed filter element it will quickly ruin the engine.

FUEL FILTER

Take the filter out of the fuel tank using a small wire hook. Disconnect the filter assembly from the fuel pipe and unhook the retainer to disassemble it. Clean the components with petrol.

A clogged fuel filter will reduce the power of the engine.



SPARK PLUG

Remove and inspect the spark plug and clean the electrodes as necessary with wire brush.

The spark gap should be adjusted to 0.6~0.7mm.

If a new spark plug is fitted it must be the same type as the original one.

555690 - Spark plug- NGK BPMR7A
BC-230B-S2 / 260B-S2 / BC260-S2

555691 - Spark plug - NGK BPMR6A
BC325-S2

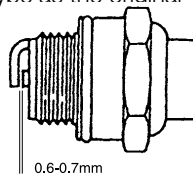

COOLING AIR INTAKE VENT

- Check the cooling air intake vent and the area around the cylinder cooling fins, and remove any waste which has attached itself to the brushcutter.
- Failing to keep the air path clear could cause the muffler to become overheated, and this in turn could cause the brushcutter to catch on fire.

GEAR CASE (BC 260 S2 and BC 325 S2 only)

- Remove the screw from the side of the gearbox.
- Remove the cutter and the inner flange to allow old grease to exit.
- Using a grease gun, supply multi-purpose grease after every 25 hours of use.

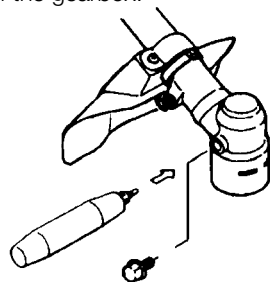

AFTER 100 HOURS USE

MUFFLER

1. Remove the muffler, insert a screwdriver into the vent, and scrape away any carbon buildup. Scrape away any carbon build-up on the muffler exhaust vent at the same time.
2. Tighten all screws, bolts, and fittings.
3. Undo the four socket screws holding the engine to the housing at the top of the main tube and check to see if any oil or grease has worked its way in between the clutch lining and drum. If it has, wipe it away using oil-free, lead-free petrol.



ADJUSTING THE CARBURETTOR

A wrong adjustment may cause damage to your unit. If the engine does not run well after adjusting the carburettor, please contact your service agent.

Adjustments & service are not covered by warranty.

IDLE ADJUSTMENT SCREW (All models)

The horizontal screw (1) contacting the side of the butterfly lever arm on top of the carburettor adjusts the idling speed. If you turn right (clockwise), idle speed increases, and left (counterclockwise) it decreases. Adjust the speed if the blade continues to rotate when the engine is idling (not applicable to the BC 230B S2 model), or if the engine stops when you release the throttle lever.

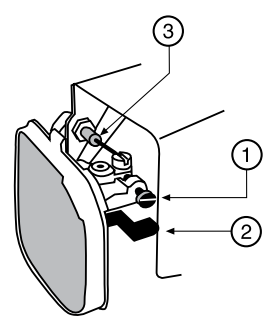
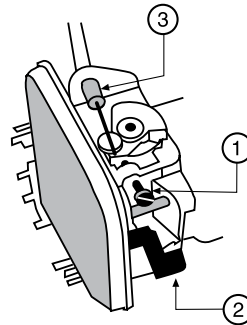

BC 260 S2, BC 260B S2 and BC 325 S2 Idle Adjustment
BC 230B S2 Idle Adjustment

1. Idle adjustment screw
2. Choke lever
3. Throttle cable

MAINTENANCE BEFORE STORAGE

1. Clean the machine down thoroughly and inspect for any wear or damage. If you find any, have it corrected so the machine will be ready for use next time.
2. Empty the fuel from the tank. If the engine will start, run it until it stops from lack of fuel.
3. Remove the spark plug and put in 1~2 drops of 2-cycle oil in the engine. Pull the starter rope 2~3 times and then replace the spark plug.
4. Apply anti-rust oil to the metal parts such as the throttle wire, put the cover on the blade, and store it indoors, avoiding dampness.

SPECIFICATIONS

	BRUSHCUTTER MODEL				
FEATURE	BC230B S2	BC 260B S2	BC260E/B S2	BC260 S2	BC325 S2
ENGINE TYPE	1E32F	1E34F	1E34F-2E (EU V)	1E34F	1E36F
WEIGHT	4kg	5 kg	5.9kg	5.3 kg	7 kg
TRANSMISSION	Direct	Centrifugal Clutch	Centrifugal Clutch	Centrifugal Clutch/ Spiral Gear	Centrifugal Clutch/ Spiral Gear
ENGINE TYPE	2 Stroke	2 Stroke	2 Stroke	2 Stroke	2 Stroke
DISPLACEMENT	21.4 cc	25.4 cc	25.4 cc	25.4 cc	30.5 cc
CARBURETTOR	Diaphragm	Diaphragm	Diaphragm	Diaphragm	Diaphragm
MAXIMUM CUTTER RPM	7500	6200	6200	8500	8000
MAX. PERFORMANCE	0.5 kw	0.75 kW	0.70 kW	0.75 kW	0.81 kW
IDLING SPEED RPM	3300	2300	2800	2300	2300
STARTING METHOD	Recoil Starter	Recoil Starter	Recoil Starter	Recoil Starter	Recoil Starter
CUTTER	Nylon cutter	Nylon cutter	Nylon cutter	"Nylon cutter, 3 tooth blade 8 tooth blade"	"Nylon cutter, 3 tooth blade, 80 tooth blade"
CUTTING DIAMETER	340 mm	390 mm	390 mm	250 mm, 420 mm	250 mm, 420 mm
FUEL / OIL (Page 8)	25:1 fuel mix	25:1 fuel mix	25:1 fuel mix	25:1 fuel mix	25:1 fuel mix
FUEL TANK CAPACITY	400ml	700ml	650ml	700ml	800ml
OIL	2 stroke engine oil	2 stroke engine oil	2 stroke engine oil	2 stroke engine oil	2 stroke engine oil
CUTTER ROTATION	Clockwise from operators viewpoint	Clockwise from operators viewpoint	Clockwise from operators viewpoint	Counter clockwise from operators viewpoint	Counter clockwise from operators viewpoint
SPARK PLUG	NGK-BPMR7A	NGK-BPMR7A	NGK-BPMR7A	NGK-BPMR7A	NGK-BPMR6A
NYLON SIZE	1.7mm	2.4mm	2.4mm	2.4mm	2.4mm

Recommended Cutter Applications

CUTTER	APPLICATION				
DESCRIPTION	Lawn Edging	Lawn Trimming	Long Grass	Succulent Growth less than 25mm dia.	Woody Growth & Succulent Growth over than 25mm dia.
Nylon Cutter	✓	✓✓	X	X	X
3 Tooth Blade	X	X	✓✓	✓	X
8 Tooth Blade	X	X	✓✓	✓✓	X
80 Tooth Blade	X	X	✓	✓✓	✓✓

x = NOT SUITABLE
 ✓ = SUITABLE
 ✓✓ = MOST SUITABLE

Morrison, a division of Masport Limited
1-37 Mt Wellington Highway
Panmure
Auckland 1060
New Zealand
P: 0800 627 767

Masport Australia Pty Limited
1/40 Abbots Road, Dandenong
South Victoria 3175
Australia
P: 1300 366 225

MORRISON[®]